

# UNI-OFS7C1 & UNI-OFS7T1

Security Camera Enclosures

**SONY**  
make.believe

## Vandal Resistant Outdoor Recessed Dome

The UNI-OFS7C1 & UNI-OFS7T1 are 7-inch recessed dome enclosures that offer vandal resistance, versatility, easy installation and camera protection in a compact size. These inconspicuous, recessed dome housings are specifically designed to accommodate the Sony SNC-RZ30 and SNC-RZ50 PTZ cameras.



### KEY FEATURES

- Designed for SNC-RZ30 and SNC-RZ50 model of PTZ cameras.
- Vandal resistant, heavy duty construction, rated to IK10 standards.
- Designed to be water and dust tight to IP66 standards.
- UL rated for drop ceiling applications.
- Easy camera installation and servicing from below the ceiling or overhang.
- Includes a decorative trim ring with safety lanyard and captive security fasteners.
- Optically clear 0.118-inch (3mm) thick aspheric polycarbonate dome.
- Thermostatically controlled 24VAC heater.
- 24VAC input with separate power inputs for heater, blower and camera power and regulated DC 12V with connector to cameras included.
- RoHS, WEEE, UL, CE compliant.

### BID SPECIFICATIONS

- The outdoor dome camera housing shall be a Sony model UNI-OFS7C1, UNI-OFS7T1. The housing shall be designed for the SNC-RZ30 and SNC-RZ50 model of PTZ cameras. These models shall also be equipped with 24VAC input blowers and thermostatically controlled heaters. The back box shall be constructed from heavy 10 - gauge aluminum and be capable of being installed in its entirety from below the ceiling. The top will measure (H x D) 6.75 x 9.16 inches. The lower dome shall be made of an injection molded, 3mm thick, optically clear thermoplastic polycarbonate (1 F-stop light reduction for tinted lower dome). The lower dome shall be held in place with a die-cast aluminum trim ring (white powdercoat finish) that attaches with a minimum of three (3) security fasteners. The UNI-OFS7C1 / UNI-OFS7T1 shall be designed to be installed in either sheetrock or hard ceiling surfaces. Three rotating support arms will allow for adjustment to the ceiling material thickness. The unit shall be fully sealed, designed to meet IP66 dirt/water ingress rating. Unit will include thermostatically controlled 25-watt heater and blower unit. The blower shall draw 1.4W continuous power. The 25W heater shall turn on at 50°F (10°C) and turn off at 77°F (25°C). The housing shall support a temperature range of -20°F (-29°C) to 122°F (50°C).
- Note: To achieve the increased depth with the aspheric design for optimal camera lens to capsule orientation, the capsule is slightly angled around the highest section. This creates a "line", visible to the naked eye, around the upper most section of the capsule. This "line" serves as the geometric center line used to insure proper camera placement. It is not typically seen by the camera except with those models that have above the horizon tilt capability.

## SPECIFICATIONS

UNI-OFS7C1 & UNI-OFS7T1	
<b>Mechanical</b>	
Size (H x W x D)	11.2 x 11.2 x 11.5 inches (284 x 284 x 292mm)
Weight	9 lbs. (4.1 kg) without camera
Upper Housing	10 gauge aluminum, powdercoated
Trim Ring	Die-cast aluminum, powdercoated
Lower Dome	0.118-inches (3mm), optically clear, thermoplastic polycarbonate
<b>Environmental</b>	
Operating temperature	-20°F (-29°C) to 122°F (50°C)
Heater activates at	50°F (10°C), deactivates at 77°F (25°C), 24VAC, 25W
Blower activates at	Continuous operation
<b>Models</b>	
UNI-OFS7C1	Outdoor, recessed mount, clear dome enclosure with 24VAC input, 12VDC camera power and heater/blower
UNI-OFS7T1	Same specifications as UNI-ONS7C1 but with a tinted lower dome
<b>Electrical</b>	
Heater and blower	24VAC 27 watts
Camera	24VAC 25 watts
<b>Shipping</b>	
Weight	10 lbs. (4.6 kg)
Box dimensions	12 x 12 x 19 inches (305 x 305 x 483mm)

## SYSTEM CONFIGURATIONS

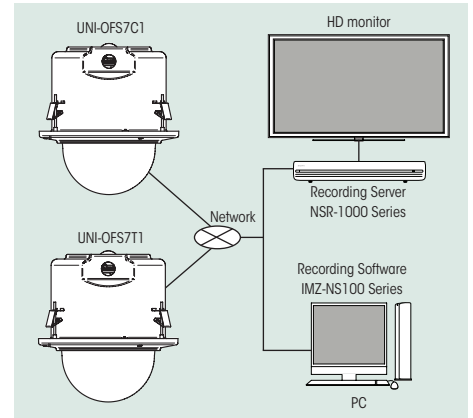

## DIMENSIONS

Unit: inches (mm)

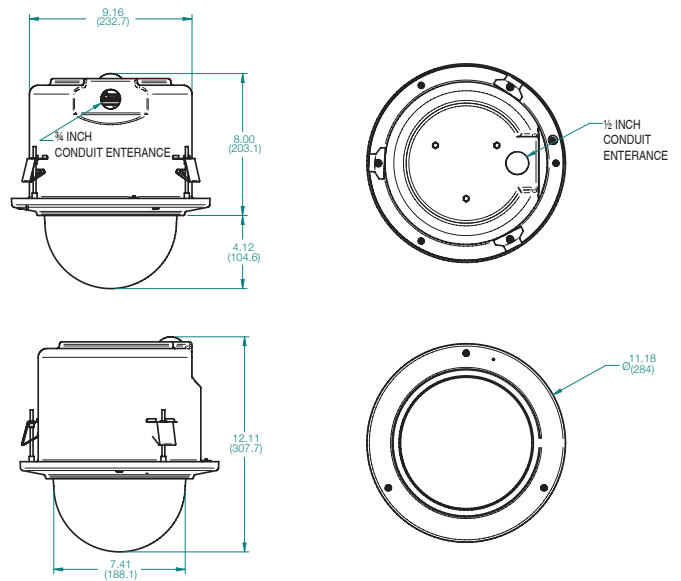

© 2012 Sony Electronics Inc. All rights reserved.  
 Reproduction in whole or in part without written permission is prohibited.  
 Features and specifications are subject to change without notice.  
 Weights and measurements are approximate.  
 Sony and the Sony make.believe logo are trademarks of Sony.

Sony Electronics Inc.  
 1 Sony Drive  
 Park Ridge, NJ 07656  
[sony.com/security](http://sony.com/security)